



CAMPERDOWN

HIGH-PERFORMANCE AZIMUTH STERN DRIVE TUG

GENERAL

Classification	Bureau Veritas A2✕ABCU✕AMS Fi-Fi 1 Escort Tug - Unrestricted Navigation
Flag	British
Owner	Targe Towing Limited
Built	2024
Fire-Fighting	Full Fi-Fi 1 (2800 m3/hr)

DIMENSIONS

Length overall	29.40m
Beam overall	13.30m
Max Draught	5.75m
Gross tonnage	493t

PERFORMANCE

Bollard pull	85t
Max Speed	12 knots

PROPULSION SYSTEM

Main engines	Caterpillar 3516C
Total power	5050kw (6772bhp) at 1800rpm
Azimuth thrusters	Kongsberg US255FP
Propeller diameter	2800mm

TANK CAPACITIES

Fuel Oil	172.5 m3
Fresh Water	21.68 m3
Foam	18.5 m3

AUXILIARY EQUIPMENT

Generator sets	2 x Caterpillar C4.4 TA, 230/400 V, 107 kVA, 50 Hz
----------------	--

DECK EQUIPMENT

Fore Winch	DMT Hydraulic driven escort winch 2500kn brake holding force. Split independent drums
Aft Winch	DMT 600m Wire 2000kn Holding force
Tow Hook	DTH 100-151P 700kN (90t)
Crane	Hydraulic foldable boom type 2t @ 6m

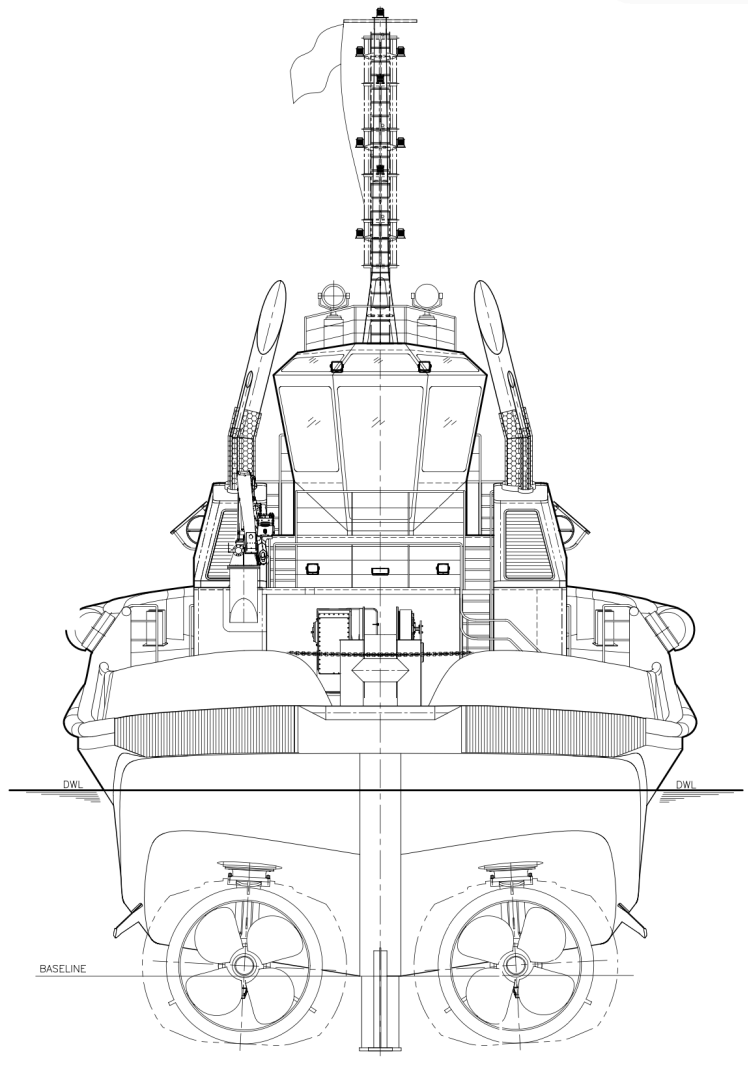
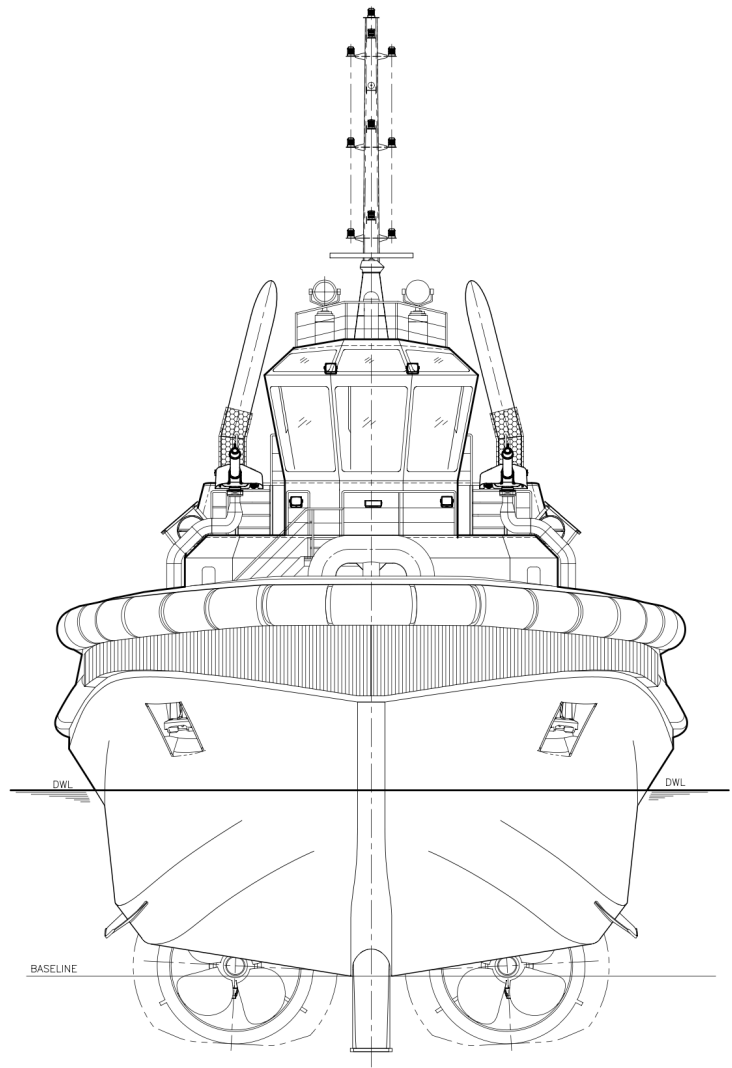
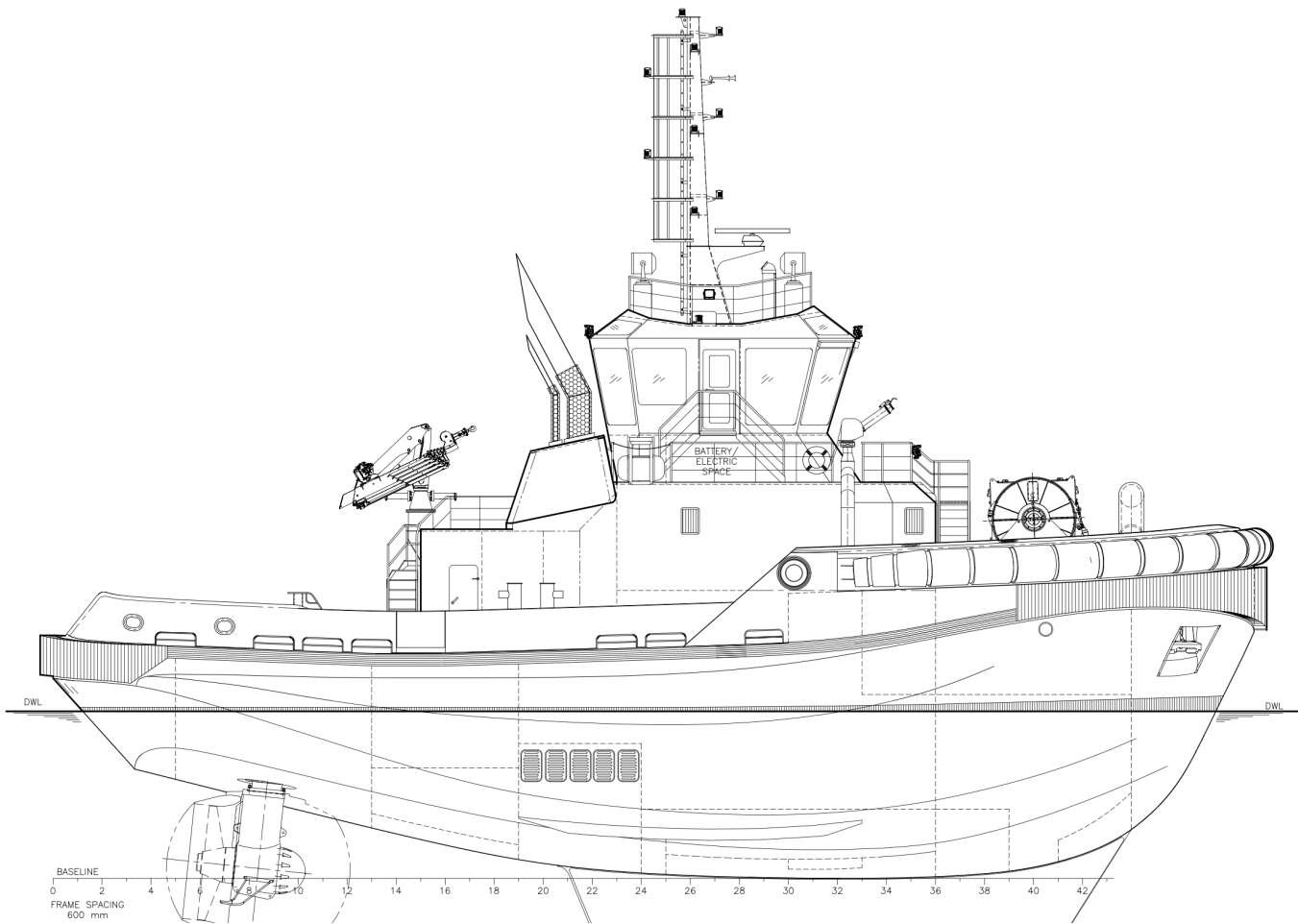

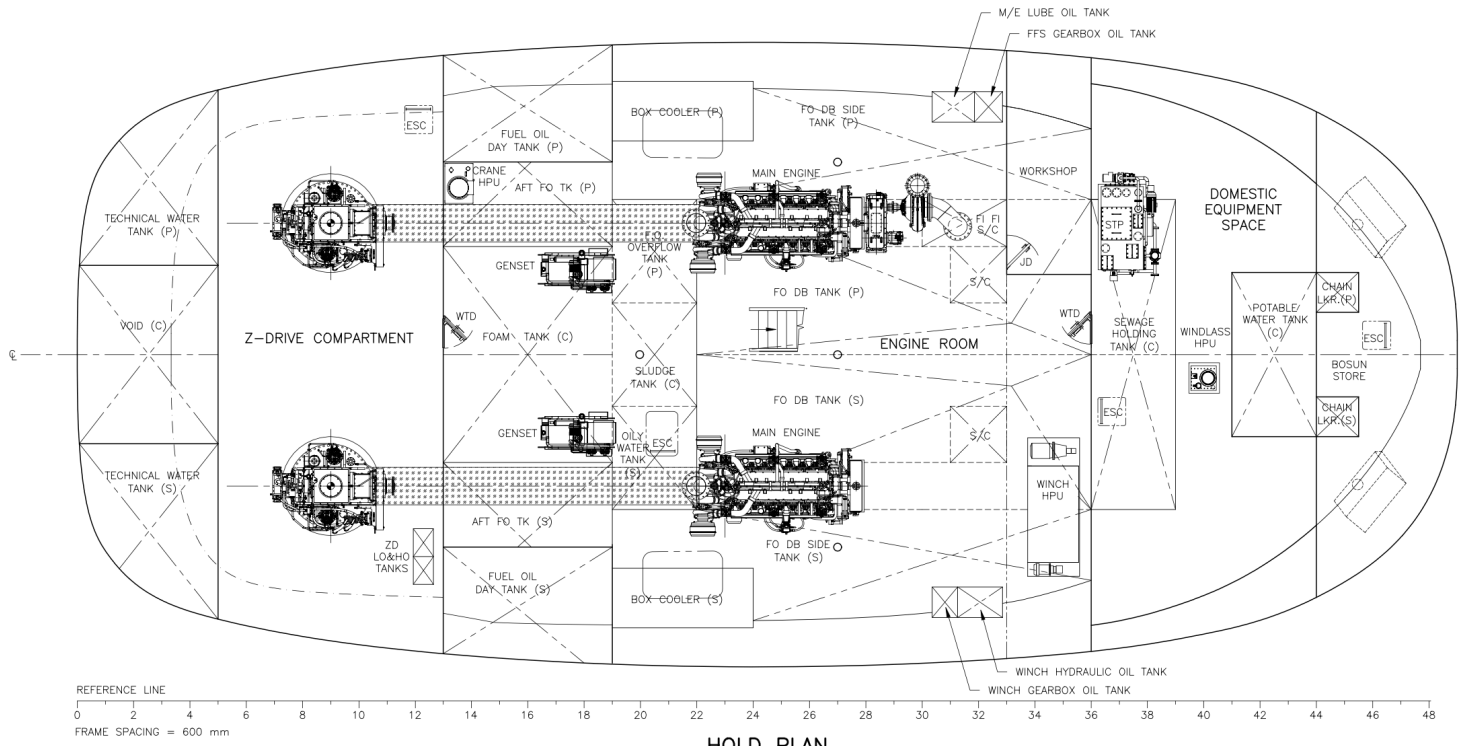

HOLD PLAN

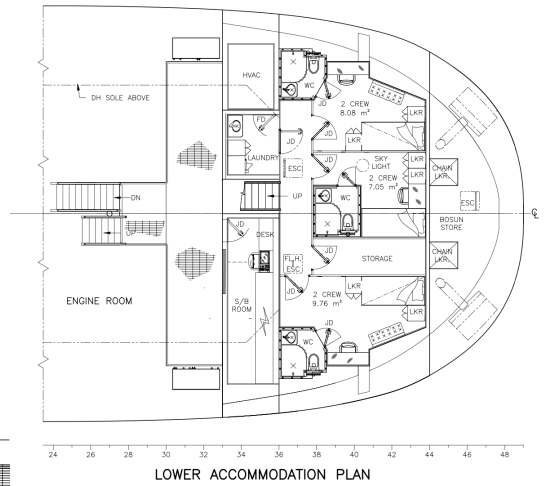

LOWER ACCOMMODATION PLAN

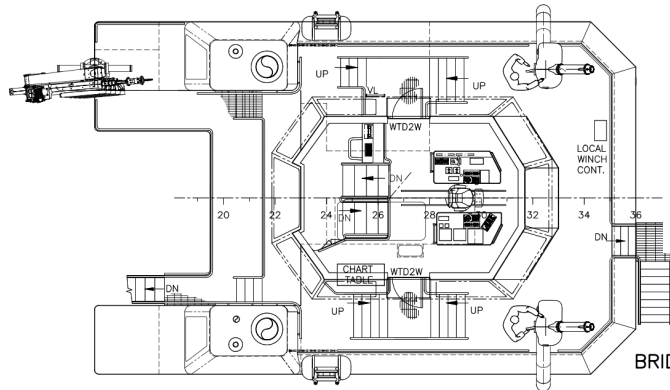

BRIDGE DECK PLAN

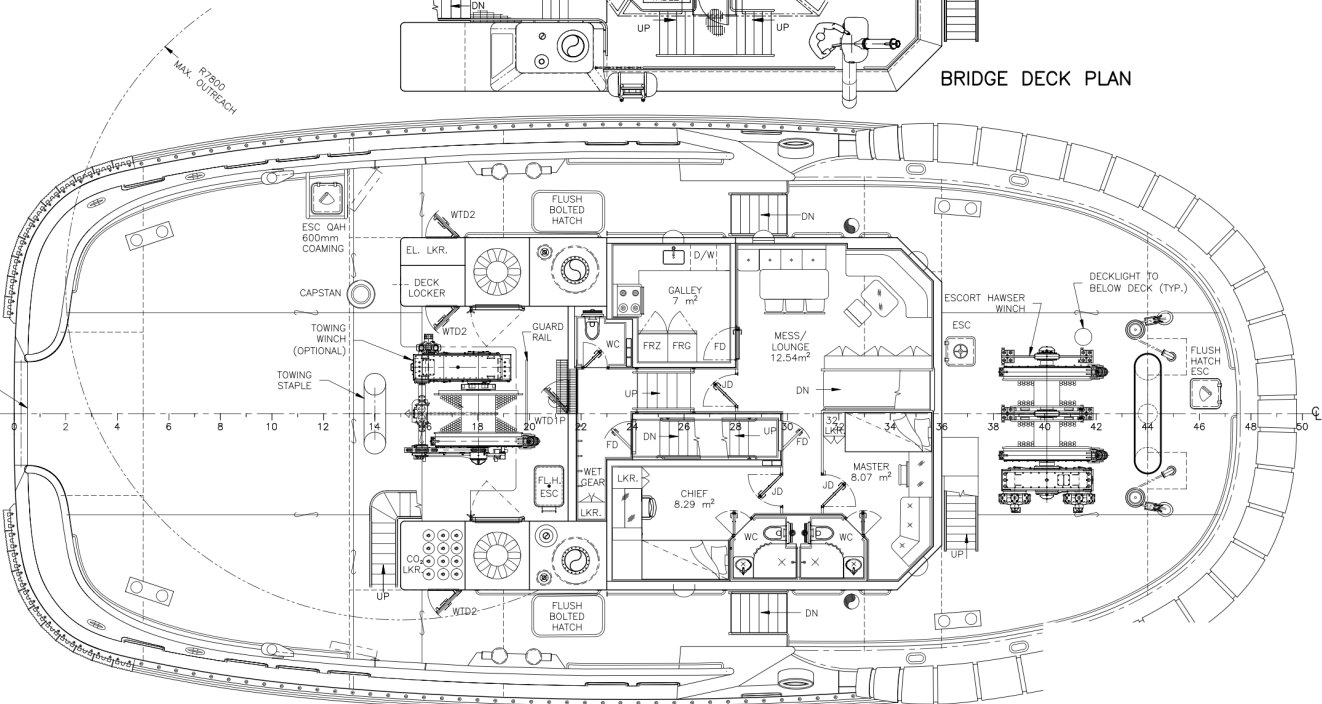

MAIN DECK PLAN

